

PRESS RELEASE

Isny, June 2020

The new Esprit: Tasteful travel at a high level

Complete revision of the series – A Class motorhomes with new double floor technology for enjoyable year-round camping - Even more comfort for travel enthusiasts - Modern design with Scandinavian touch- 4 layouts

The Esprit has always combined modern design with top-class comfort. In the new model year, it shines in a completely new splendour and has been completely revised. Its basic recipe as a motorhome with the highest value stability thanks to the Lifetime-Plus technology remains of course. New is the packaging and list of ingredients for this series, which is particularly popular with frequent travellers. A particular plus point: thanks to its new, loadable double floor, which is over 26 cm high, it not only offers plenty of storage space, but has even refined its basic recipe as a winterproof all-year-round companion. The modern, Scandinavian-influenced interior, peppered with components that make mobile living a pleasure, gives it its individual spice. In addition, since it is well known that we eat with our eyes, the A Class models with their aerodynamic design are a visual treat from the outside as well.

Speaking of food: The fully equipped kitchen of the Esprit was developed by professional hobby chefs who want to spoil their loved ones with all kinds of delicacies even on holiday. Depending on the floor plan, you can eat in the comfortable L-shaped seating area or in a lounge-like seating area, which offers sufficient space for a multi-course meal with friends.

And then there's the right ambience with the optional "Light Moments" lighting composition, which brings not only light, but above all mood and good atmosphere into the motorhome. Overall, the new Esprit is a successful creation that will certainly appeal to the taste of many motorhome enthusiasts.

PRESS RELEASE

Extremely tasteful packaging

The new Esprit adopts the graceful, clear and flowing lines of Dethleffs' own design language, which is especially reflected in the aerodynamic front and the slightly retracted rear of the integrated models.

It is based on a Fiat Ducato AL-KO low-frame chassis with a 266 mm high double floor that can be loaded and is ideal for year-round use. This enables a level living area from the driver's cab to the bathroom without steps. The Dethleffs LifetimePlus body technology guarantees longevity as well as optimum protection and thus the highest possible value stability of the entire body. This means that the Esprit remains a loyal and stable holiday companion for years to come.

The permissible total weight of all four Esprit floor plans is 4,250 kg. Thanks to the reinforced rear lowering, the felt-lined garage can take loads of up to 250 kg and can hold all kinds of bulky holiday equipment. The rear garage doors, which come as standard on the left and right, can be opened easily with one hand. Practical and shapely flush fitting windows and the wide, centrally lockable body door with window and two-point locking round off the exterior of the revised series perfectly.

The standard 140 HP make travelling with the Esprit a nippy experience, and the high-quality captain seats with ergonomic height, tilt and integrated belt and seat cushion adjustment for a wide range of body shapes and sizes guarantee a truly comfortable experience. In addition, all standard safety components such as ABS, ESP, ASR, Hill Holder and Hill Descent Control are standard on board. For an even better driving experience, special captain seats with air-swing can be ordered as an option, which can even be equipped with ventilation for hot days or seat heating for cold days. These air-swing seats automatically adapt to the body weight and automatically adjust to the road conditions with a progressive damper. This provides the best possible vibration comfort for the driver in all road conditions.

PRESS RELEASE

Special ingredients in the interior

The interior of the reworked Esprit presents itself open and with a fresh, Nordic breeze, which radiates a near-natural component by means of profiled wood décor and thus, despite the modern design, radiates a homely cosiness. The Scandinavian design of the furniture invites you to relax and feel good, especially through the refined combination with the modern country house style. The cosy hygge feeling is intensified by the optionally available light composition "Light Moments", which creates a harmonious ambience of enjoyment and relaxation through several light levels. Especially the light tracks near the floor give the interior a light and floating feeling. Homogeneous transitions and the straight lines of the furniture construction bring additional clarity and calm to the interior of the motorhome.

There are several options for the upholsteries. As standard, you can choose between the upholstery colour Kari in modern grey or Nubia, a combination of cream and beige tones. Those who prefer to sit on real leather can choose either the colour variant Cream or another leather colour for an additional charge and thus give their interior an individual touch. All Dethleffs upholsteries have been made up in such a way that they match perfectly with the wood grain and the locker doors in Greige high gloss - a tasteful combination of grey and beige.

The heart of the Esprit is the kitchen, as in any cosy house. It boasts a real professional gas cooker with solid hobs, a black high-gloss surface and different power levels of the three hobs. The pressure cooker has a power of 1.6 KW. Even complicated holiday dishes can be prepared here in no time at all. By the way, thanks to the extractor fan with exhaust air including non-return valve, no odours will be trapped inside; and, air from outside will not enter the vehicle unintentionally.

PRESS RELEASE

Large drawers that can be centrally locked as standard, a 177 l refrigerator that can be opened from both sides and a practical pharmacy pull-out offer plenty of space for food and all kinds of cooking utensils. On request, the Esprit even has an oven that can be placed above the refrigerator. So you don't have to do without the home-made cake even on holiday.

Dethleffs usual attention was also paid to sleeping comfort when designing the new A Class ones. The double beds have a comfortable width of 160 cm and can be extended to a length of two meters. The single bed versions are available in two heights and can easily be combined to a huge double bed. Sleep on 7-zone comfort mattresses and ergonomically adapted wooden slatted frames. All Esprit models come with an electric pull-down bed as standard.

As an option, the A Class models are also available with the ALDE hot water heating system, a fixed tank toilet, hydraulic lifting jacks including weighing function or a 32-inch TV set, which is virtually gigantic for motorhomes. Even a macerator toilet is available on request.

Der Esprit GT: sporty, distinctive and individual

If desired, the new Esprit can also be ordered in the Gran Turismo variant Esprit GT. The Gran Turismo Package includes a wide range of special equipment and design elements that make travelling even more comfortable and chic. You can choose between the exterior designs in white or black. Components such as 16-inch aluminium rims, the dashboard with aluminium application and air-swing captain seats make the GT a sporty-looking gem. For enhanced comfort, there is automatic air conditioning, cruise control, a large roof window and the luxury version of the on-board control panel. The package includes everything the motorhome owner's heart desires

PRESS RELEASE

Layouts

The new Esprit is available in four layouts, all of which are 7.81 m long, 233 cm wide and 304 cm high. All models have a technically permissible total weight of 4.25 tonnes and can be optionally loaded up to 4.5 tonnes if required. The models offer a choice of two single bed and two queen bed layouts, each of which differ in the arrangement of the seating options. The **I 7150-2 EBL** and the **I 7150-2 DBL** come with a lounge-like seating group, which makes the interior of the integrated unit appear even larger. The Esprit **I 7150-2 DBM** and the **I 7150-2 EB** have an L-shaped bench seat in the direction of travel and an additional, comfortable seat for an additional guest, which can also be optionally arranged as a 5th belt seat.

In all models, the shower and washroom are separate and can be connected by doors to form a large bathroom. The wardrobes are under the single beds or to the right and left of the double bed, depending on the arrangement of the bed.

Layouts Esprit

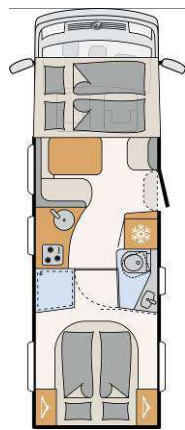

I 7150-2 DBM



I 7150-2 DBL

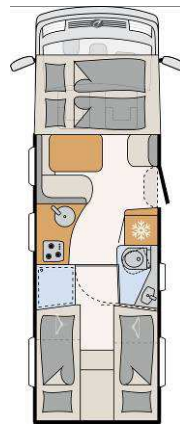

I 7150-2 EB

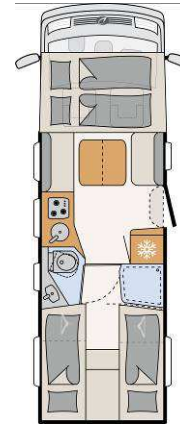

I 7150-2 EBL

PRESS RELEASE

About Dethleffs

“Not without my family!” This decision taken by Arist Dethleffs in 1931 inspired him to design Germany’s first ever caravan, which he called the “Wohnauto” (original camper) – all because the ski pole and horsewhip maker wanted to have his family by his side when he went on long business trips. Very few people were familiar with the word “leisure” back then; family holidays were a privilege and tourism was still in its infancy. The invention of the Dethleffs caravan marked the beginning of a new era – especially for the company, which eventually devoted itself entirely to the production of caravans, followed by motorhomes.

The pioneering spirit of Arist Dethleffs can still be felt throughout the company to this day. It can be found in the ongoing development of model ranges, in the countless innovations and, needless to say, at the heart of the Dethleffs camping story – the family. The company has had close ties with Isny im Allgäu since the very beginning and, with its position as a “Friend of the family”, has its sights firmly set on the core values of the brand.

In addition to motorhomes and caravans of the Dethleffs brand, camper vans and urban vehicles for the Pössl and Crosscamp brands are also developed and produced in Isny.

Erwin Hymer Group

The Erwin Hymer Group is a 100 per cent subsidiary of Thor Industries, the world’s leading manufacturer of leisure vehicles with more than 25,000 employees worldwide. The Erwin Hymer Group unites motorhome and caravan manufacturers as well as motorhome and caravan accessory specialists, hire and financing services under one roof. The motorhome and caravan brands Buccaneer, Bürstner, Carado, Crosscamp, Compass, Dethleffs, Elddis, Eriba, Etrusco,

PRESS RELEASE

Hymer, Niesmann+Bischoff, Laika, LMC, Roadtrek, Sunlight and Xplore, the motorhome rental companies McRent and rent easy, and also the chassis specialist Goldschmitt, the accessories specialist Movera and the touring portal freeontour all belong to the Erwin Hymer Group.